

Owners Manual and Operating Instructions

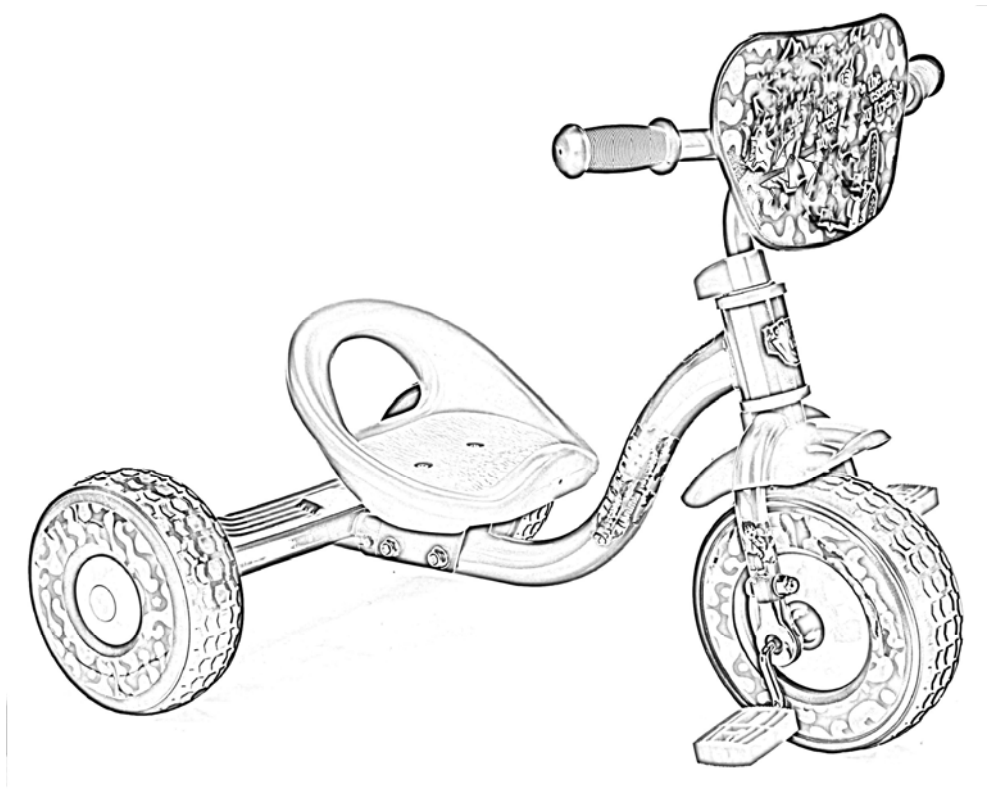

ADULT ASSEMBLY REQUIRED

USE ONLY UNDER ADULT SUPERVISION

**READ AND FOLLOW THE INSTRUCTIONS IN THIS MANUAL
COMPLETELY**

**THE RIDER MUST ALWAYS WEAR PROPER PROTECTIVE GEAR
INCLUDING A CPSC APPROVED HELMET WHILE OPERATING THE
PRODUCT**

**IF YOU HAVE A PROBLEM WITH THIS PRODUCT, BEFORE RETURNING
IT, PLEASE CALL CUSTOMER SERVICE AT THE NUMBER IN THIS
MANUAL.**

Safety Information

PLEASE READ AND FULLY UNDERSTAND THIS OWNERS MANUAL BEFORE OPERATING
THE PRODUCT

KEEP THIS MANUAL FOR FUTURE REFERENCE



This symbol is important. It is the **WARNING** symbol. The warning symbol precedes safety instructions. Make sure the child understands these instructions. Failure to follow these instructions may result in injury to the rider or to others.



WARNINGS:

- Adult assembly is required.
- Adult supervision is required.
- This product should only be used by persons 3 years and up.
- Never ride with more than one person. Maximum weight is 27kg. (60 lbs).
- Do not allow a child to ride without an approved helmet, with the chinstrap securely fastened.
- Do not allow a child to ride without shoes.
- Do not allow a child to ride the product at dusk, at night or at times of limited visibility.
- Do not allow a child to ride on roadways or alleys.
- Do not allow a child to ride off road, on grass or wet surfaces.
- Do not allow a child to ride on sloped driveways or hills.
- Do not allow a child to ride near steps.
- Do not allow a child to ride near swimming pool areas, or other bodies of water.
- Always comply with local laws and regulations.
- For use on smooth paved surfaces only.
- Understand all operating procedures before use.
- Do not tow or pull any objects with the product.
- Do not push or pull a child riding on the product.
- Replace worn or broken parts immediately.

**IF YOU HAVE ANY QUESTIONS REGARDING THE OPERATION OF THIS
PRODUCT, PLEASE REFER TO THIS OWNERS MANUAL
OR CONTACT US.**

Tools Required For Assembly

Phillips screwdriver
Small adjustable wrench

Assembly Instructions

Do not discard any of the packaging materials until you have finished assembly of the product to ensure that you do not accidentally discard any parts.

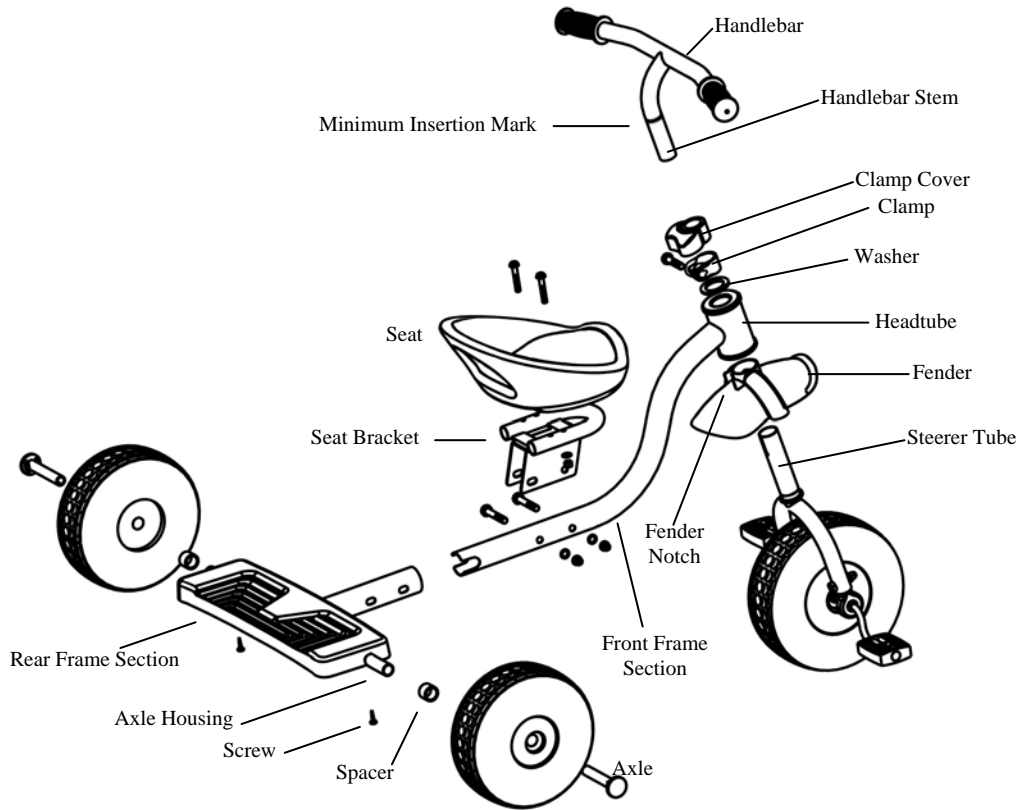

(All models may not have all features shown)



WARNING! An adult must assemble this product. Keep small loose parts and plastic bags out of the reach of children.

Rear Wheel to Rear Frame Assembly:

- Place one spacer on the rear axle housing.
- Insert one axle through one of the wheels
- Insert the wheel / axle assembly into the axle housing.
- If necessary, rotate the axle until the tab in the axle inserts into the notch in the axle housing. This will align the hole in the axle with the hole in the underside of the axle housing.
- Secure the axle in the axle housing with the screw.
- Repeat for the other side.
- Ensure both axles are secure, and the wheels rotate freely on the axles.

Seat to Seat Bracket Assembly:

- Place seat onto the seat bracket. Use the two holes toward the front of the bracket for a smaller child, and the two holes toward the rear of the bracket for a taller child.
- Insert a seat mounting screw through the seat and the seat bracket from top to bottom.
- Install a washer and then a nut onto each seat mounting screw.
- Tighten them sufficiently to ensure they will not come off.
- Do not over tighten them, as this could damage the seat.

Front to Rear Frame Assembly:

- Slide the front frame section over the rear frame section until both holes in each section align.
- Insert the two frame bolts through the two holes.
- Install a washer and then a nut onto each frame bolt.
- Tighten them sufficiently to ensure they will not come off.

Seat Bracket to Frame Assembly:

- Locate the seat bracket onto the frame with the seat pointing toward the front
- Align the two holes in the seat bracket with the two holes in the frame.
- Insert the two seat bracket bolts through the two holes.
- Install a washer and then a nut onto each seat bracket bolt.
- Tighten them sufficiently to ensure they will not come off.

Front Assembly:

- Slide the fender onto the steerer tube.
- Ensure the notch in the fender and the slot in the steerer tube are aligned.
- Install a bushing on the top and bottom of the headtube with the steering limiter slots toward the rear (This is pre-assembled on most models.)
- Slide the steerer tube through the headtube with the slot in the steerer tube toward the rear.
- Ensure the fender notch inserts into the steering limiter slot on the bottom headtube bushing.
- Place the large washer, and the clamp onto the steerer tube with the open end and clamp bolt toward the rear & aligned with the slot in the steerer tube.
- Slide the clamp cover as far up the handlebar stem as it will go.
- Insert the handlebar stem into the steerer tube.
- Ensure the minimum; insertion mark is not visible – below the top of the steer tube.
- Align the handlebar with the front axle.
- Secure the handlebar in the steertube by tightening the clamp nut / bolt assembly.
- Assemble the accessories (plaque, bag, bell, streamers) – if equipped, to the handlebar.



WARNING! The minimum insertion mark must be below the top of the steer tube.



WARNING! Check all fasteners to ensure they are tight.



WARNING! Check pedaling, steering, and rear wheel operation to ensure they function properly.

Adjustment Instructions

This product is designed to adjust for the size of the rider as described above.



WARNING! After adjusting the seat or handlebar, ensure the fasteners are secure before use.

Operating the Product

After properly assembling the product, the product is ready for use.

Ensure the rider is aware of all operating features. **Adult supervision is required.**

Maintenance

Proper maintenance is required to ensure the product continues to operate properly.

- Keep the product clean and free of dirt, dust and water. This will prolong the useful life of the product.
- Frequently check the product and replace any damaged, missing or badly worn parts.
- Frequently check all screws and fasteners, re-tighten any that are loose, replace any that are missing or damaged.
- No lubrication is required.



WARNING! If anything does not operate properly, discontinue use.

Limited Warranty

Part or model specifications are subject to change without notice.

This Limited Warranty is the only warranty for this product. There are no express warranties. The only uses for this product are described in this manual. Warranty registration is not required. This limited warranty extends only to the original consumer and is not transferable.

What does this Limited Warranty cover?

This Limited Warranty covers all parts of the product.

What must you do to keep the Limited Warranty in effect?

This Limited Warranty is effective only if:

- the product is completely and correctly assembled;
- the product is used under normal conditions for its intended purpose (see “Warnings” for excluded activities);
- the product receives all necessary maintenance and adjustments.

What is not covered by this Limited Warranty?

This product is designed for recreational use only. This Limited Warranty does not cover normal wear and tear, normal maintenance items, or any damage, failure, or loss that is caused by improper assembly, maintenance, adjustment, storage, or use.

This Limited Warranty is void if the product is ever:

- used for stunt riding, jumping, acrobatics, or similar activity;
- ridden by more than one person at a time, or the weight limit is exceeded;
- used in a manner contrary to the instructions in this manual.

How long does this Limited Warranty Last?

All components are warranted for 90 days from the date of purchase.

What will the manufacturer do?

The manufacturer will replace, without charge to you, any component found to be defective. The original owner must pay all labor and transportation charges associated with the repair or warranty work.

How do you get service?

Contact customer service.

What rights do you have?

This Limited Warranty gives you specific legal rights. You may also have other rights which vary from state to state.